

CHUCK	APPLICATION	OCTG PRODUCT	CUSTOMER BENEFITS
SF-RZ Page 28 	NEW Hydraulic ring indexing chuck for threading of couplings in 1 set up with the original SMW Type SF-RZ (3 jaw self centering clamping).		<ul style="list-style-type: none"> ▪ 3 jaw self centering clamping ▪ Quick jaw movement more couplings per hour ▪ Compact design and light weight ▪ Easy retrofit on existing machines
SF-RAZ Page 30 	Hydraulic ring indexing chuck for threading of couplings in 1 set up with the original SMW Type SF-RAZ (6 jaw clamping: 3 jaw self centering, 3 jaw compensating).		<ul style="list-style-type: none"> ▪ 6 jaw clamping for low deformation of coupling ▪ Quick jaw movement more couplings per hour ▪ Rigid strong design and highest accuracy for all premium couplings
BB-N Page 32 	Threading of couplings in 2 set ups with the original SMW Big Bore Type BB-N (3-jaw clamping).		<ul style="list-style-type: none"> ▪ Quick jaw movement more couplings per hour ▪ Can be used for other work pieces besides coupling ▪ O.D. and I.D. clamping
BB-N ES Page 34 	Threading of couplings in 2 set ups with the original SMW Big Bore Type BB-N ES (3-jaw clamping).		<ul style="list-style-type: none"> ▪ Quick jaw movement more couplings per hour ▪ Large jaw stroke for easy loading of couplings

SF-RZ

2 Position hydraulic ring indexing chuck

- 3 self-centering jaws
- Large evacuation windows for easy chip flow
- Fully automatic and controlled indexing

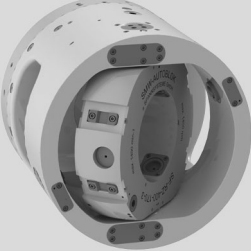
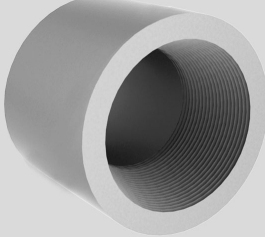
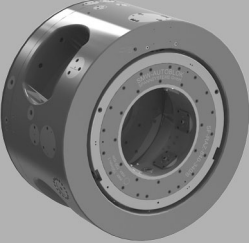
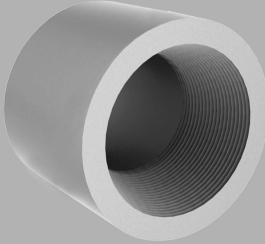
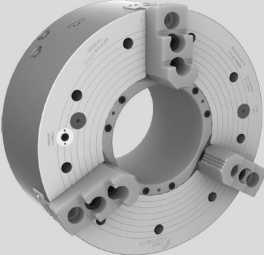
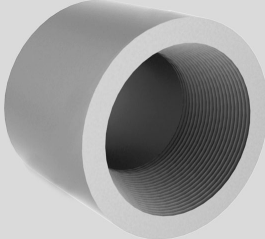
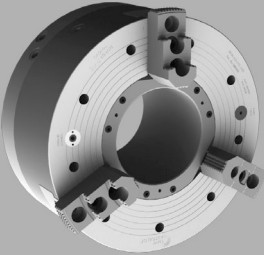
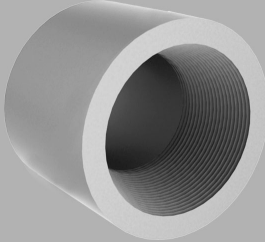
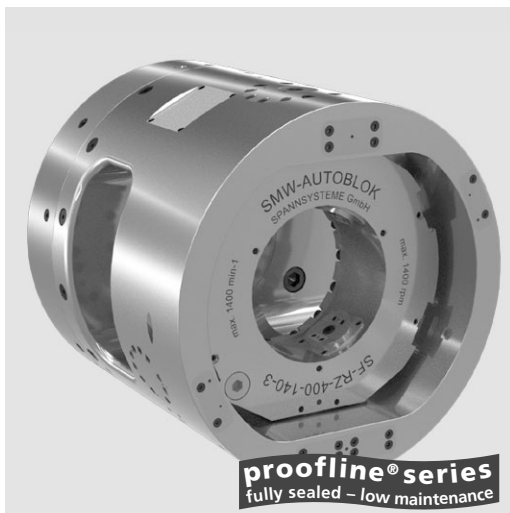

Application/customer benefits

- Machining of couplings up to 5 1/2" in one set up
- Indexing 180°
- 3 self centering jaws external clamping
- Compact design and light weight
- Standard mounting for easy retrofit on existing machines

Technical features

- Hydraulic operated, automatic ring indexing chuck
- All functions controlled by proximity switches
- Extremely accurate and rigid indexing mechanism
- Optional: pendulum clamping inserts, central coolant supply

Standard equipment

Chuck with mounting bolts

Ordering example

SF-RZ 400

Accessories

7-way oil distributor
Connection kit for coolant supply

MDV 65 7-way oil distributor

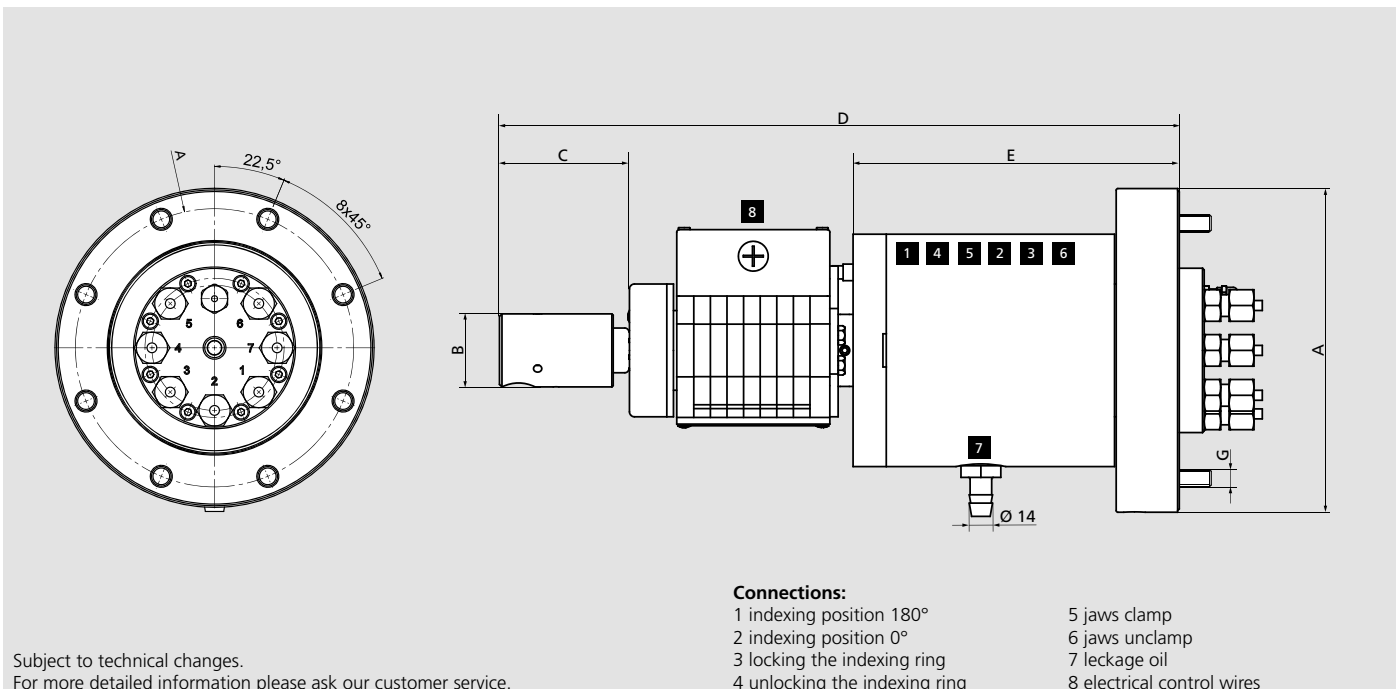

Subject to technical changes.
For more detailed information please ask our customer service.

Connections:

- | | |
|-------------------------------|----------------------------|
| 1 indexing position 180° | 5 jaws clamp |
| 2 indexing position 0° | 6 jaws unclamp |
| 3 locking the indexing ring | 7 leakage oil |
| 4 unlocking the indexing ring | 8 electrical control wires |

SMW-AUTOBLOK Type	MDV 65	
Id. No.	045920	
A	mm	195
B	mm	44
C	mm	78.3
D	mm	331.2
E	mm	196.5
F	mm	170
G	mm	8xM12
Max. speed	r.p.m.	1400
Weight	kg	28

For exact position of the connecting ports, please ask for a customer drawing.
All ports (1-6) are G 3/8".

Main dimensions and technical data

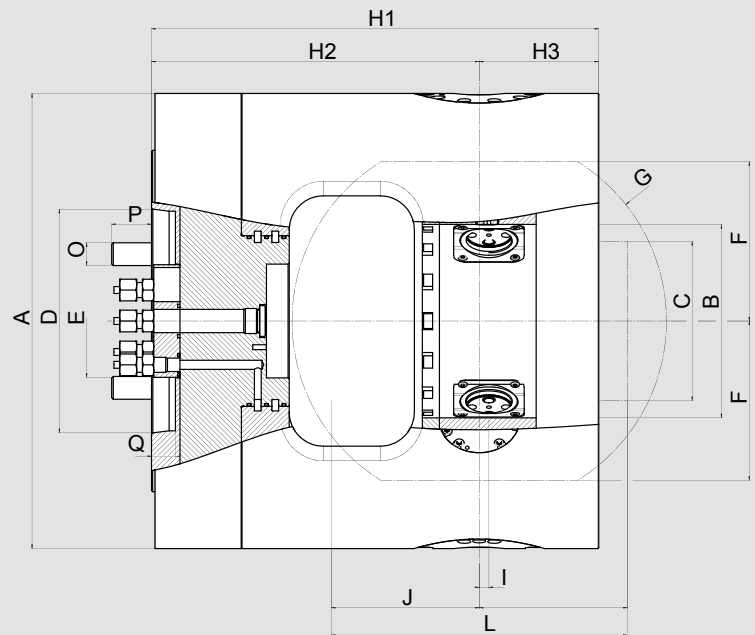
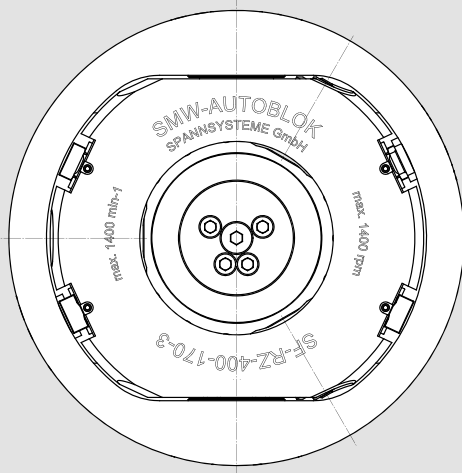

Subject to technical changes.
For more detailed information please ask our customer service.

SMW-AUTOBLOK Type			SF-RZ 400
Id. No.			054394
Chuck O.D.	A	mm	400
Indexing ring I.D.	B	mm	170
Max. workpiece O.D.	C	mm	140
Spindle mounting	D		A11
Connection flange O.D.	E	mm	99
Height indexing ring	F	mm	140
Swing indexing ring	G	mm	329
	H1	mm	393
	H2	mm	288
Indexing axis	H3	mm	105
Jaw axis to indexing axis	I	mm	8.5
	K	mm	130
Max. length of workpiece	L	mm	260
Clamping stroke	M	mm	5.7
Mounting bolts	O	mm	M20
	P	mm	35
	Q	mm	21
Max. speed		r.p.m.	1400
Max. pressure		bar	50
Max. clamping force		kN	120
Weight		kg	225
Moment of inertia		kg·m ²	6