

Hydraulischer Langhubspanner

- Backen
- Verbindungskabel LPS 4.0

SLX-125-335 Aufsatzbacke SinterGrip

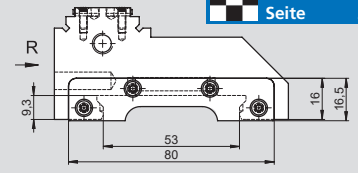
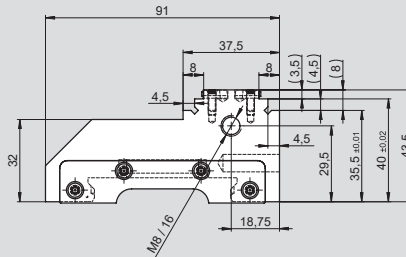
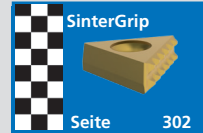
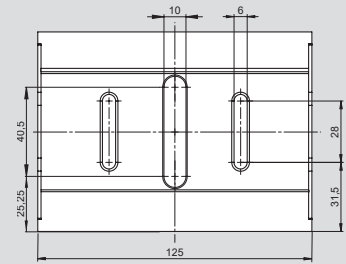
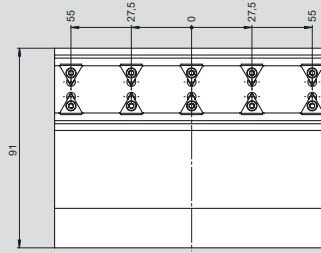
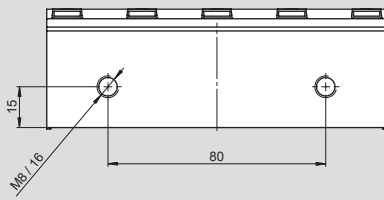
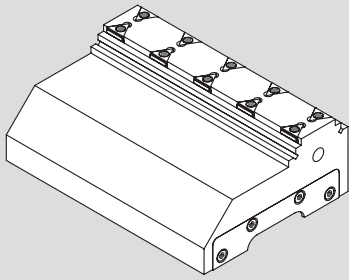

Typ	Id.-Nr.	max. Gesamtspannkraft	Spannbereich A/B m. SinterGrip	Spannbereich A/B Glatt
SLX-125-335	461521	75 kN	14,5-223,5 / 123-232 mm	9-118 / 116-225 mm

SLX-125-335-H45 weiche Aufsatzbacke

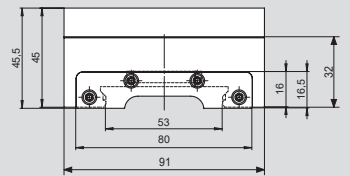
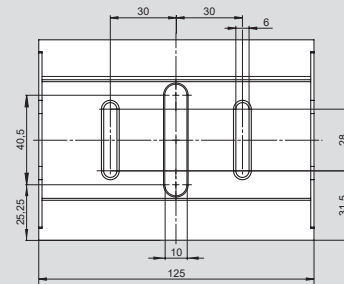
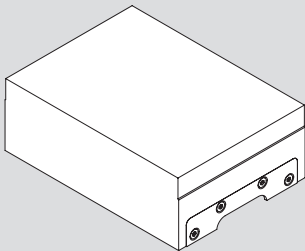

Typ	Id.-Nr.	max. Gesamtspannkraft	min. Backenhöhe	Masse
SLX-125-335-H45	461523	75 kN	32 mm	3,5 kg

SLX-125-335-H65 weiche Aufsatzbacke hoch

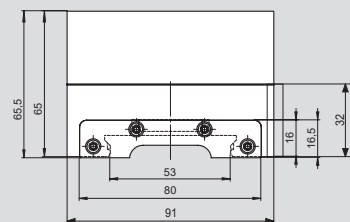
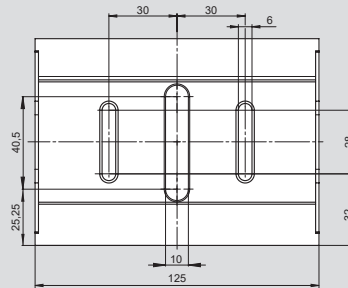
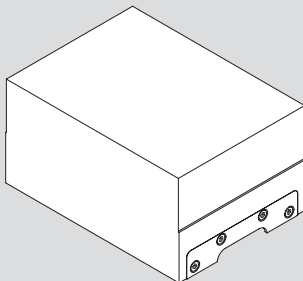

Typ	Id.-Nr.	max. Gesamtspannkraft	min. Backenhöhe	Masse
SLX-125-335-H65	461525	75 kN	32 mm	5,2 kg

Kabel* für LPS 4.0 80 IO	Länge	Id.-Nr.
Verbindungskabel mit geradem Stecker M12 x 1 5-polig	5 m	208244
	10 m	208245
	15 m	208246
Verbindungskabel mit abgewinkeltem M12 x 1 5-polig	5 m	208247
	10 m	208248
	15 m	208249

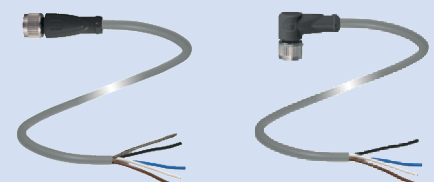

* Geschirmtes PUR-Kabel, 1 Seite mit offenem Ende, 1 Seite mit Kabelbuchse M12 x 1, vergoldete Kontakte.

Integrationsbeispiel mit Induktivkopplsystem

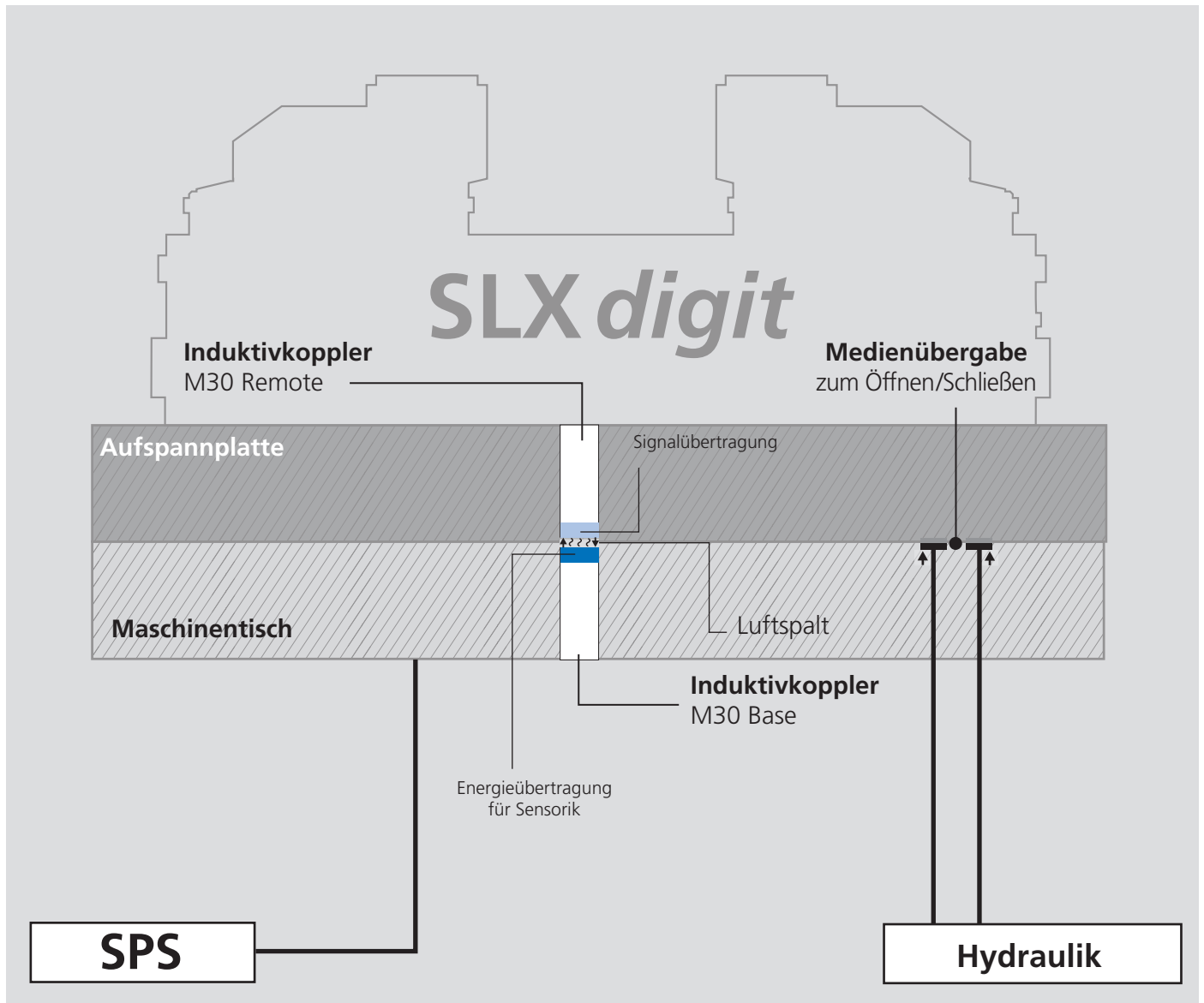

Induktive Koppelsysteme:
weitere Informationen unter www.smw-electronics.de