

- Serration 2.5 x 60°
- Quick change system „CLAK-System“ optional available



Application/customer benefits

- Full usability on CNC indexing tables
- Compact design
- Modular system: Extensive range of accessories
- Quick change system „CLAK-System“ for jaws and parallel claks optional available (see page 223)
- Maximum efficiency due to quick change over
- Can be used for single or multiclamp

Technical features

- Serration: 2.5 x 60°
- Jaw width: 38 mm, 60 mm und 90 mm, Length: 250 mm, 400 mm, 500 mm and 630 mm
- Optional: Special interface flanges for CNC indexing tables and special adaptation for end supports / tailstocks

Standard equipment

- 1 column, 4 fixed jaws, 1 blank flange, 1 interface plate for end supports / tailstocks, 1 clamping wrench, 4 workstops

Technical data

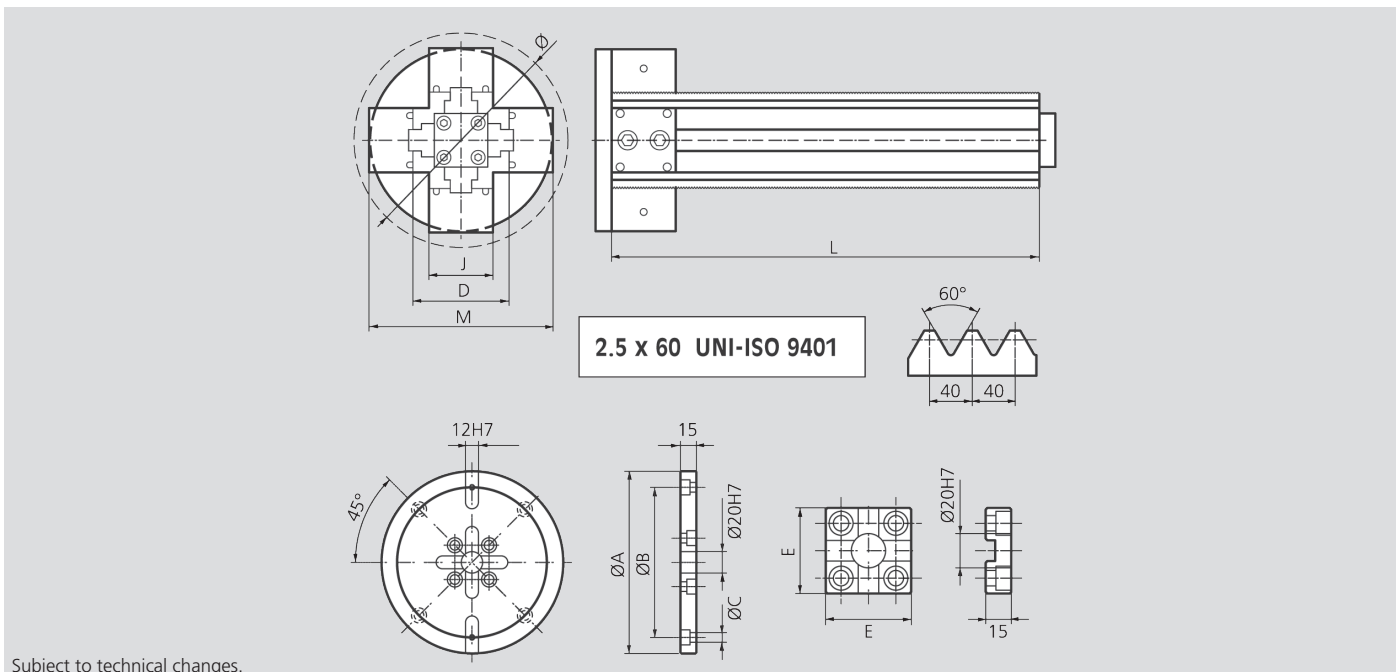

Subject to technical changes.

Type	Id. No.	J [mm]	D [mm]	M [mm]	L [mm]	Ø rot. [mm]	Ø A [mm]	Ø B [mm]	Ø C [mm]	E [mm]	Weight [kg]
CV-CN 60-400	77584111				400						19
CV-CN 60-500	77584112	60	90	170	500	200	170	140	9	50	23
CV-CN 60-630	77584113				630						29
CV-CN 90-400	77584211				400						34
CV-CN 90-500	77584212	90	115	205	500	230	210	180	11	70	41
CV-CN 90-630	77584213				630						50

