



Application/customer benefits

- Pre-assembled clamping pallet for APS 100 / 140
- Universal applicable
- Ready to use

Technical features

- Fully assembled
- Rust protected
- High quality steel (1.1730)

Standard equipment

- 1 clamping pallet: Fully assembled with 1 clamping pin (Type A), anti rotation key and hand grips
- 2 clamping pallet: Fully assembled with 1 clamping pin (Type A) and 1 clamping pin (Type B)
- 4 clamping pallet: Fully assembled with 1 clamping pin (Type A), 1 clamping pin (Type B), 2 clamping pin (Type C)

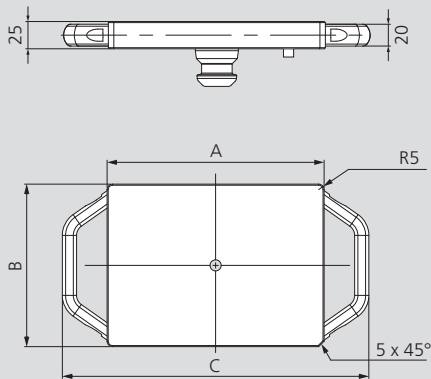

Subject to technical changes.

Type	Id. No.	A mm	B mm	C mm
Clamping pallet APS 100	46167721	149	149	231
Clamping pallet APS 140	46167722	199	149	281

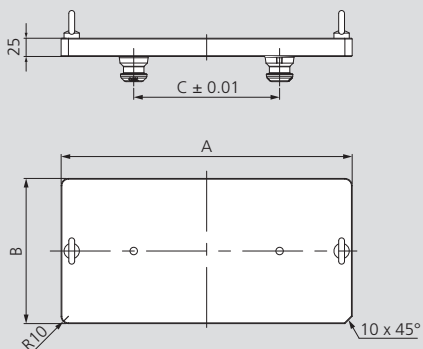

Subject to technical changes.

Type	Id. No.	A mm	B mm	C mm
Clamping pallet APS 100	46167723	299	149	150
Clamping pallet APS 140	46167724	399	199	200

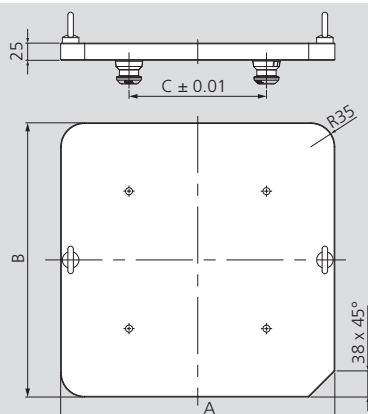

Subject to technical changes.

Type	Id. No.	A mm	B mm	C mm
Clamping pallet APS 100	46167725	299	299	150
Clamping pallet APS 140	46167726	399	399	200

Customer request data

- required for the preparation of the offer
- Simply fill in and send to:
contact@stationary-workholding.com

APS

0



Application/customer benefits

- Customized clamping pallets
- Short delivery times
- Usable for any machine or application
- Rust protected by means of burnishing

Technical features

- High quality steel (1.1730)

Standard equipment

Customized clamping pallet with transport screws
Fully assembled with APS clamping pins on request

Customized clamping pallets

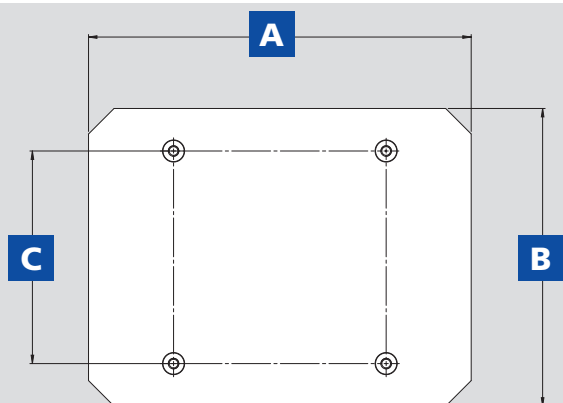

Dimensions

A	
B	
C	

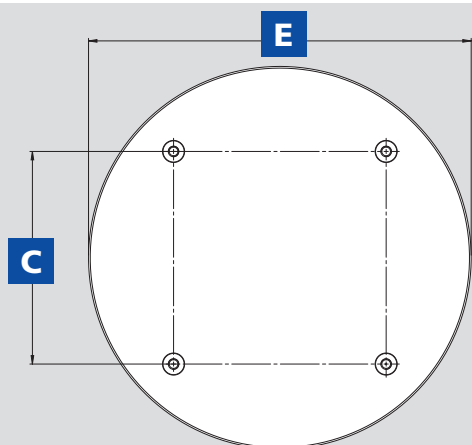

Dimensions

C	
ØE	

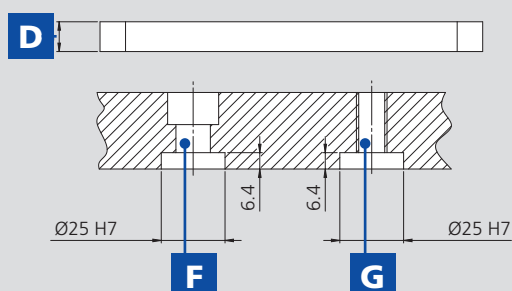

Dimensions

D		
F	<input type="checkbox"/> M12	<input type="checkbox"/> M16
G	<input type="checkbox"/> M10	<input type="checkbox"/> M12

- Basic
- Premium

Application/customer benefits

- Pre-assembled clamping pallet for APS 140
- Universal applicable
- 2 Versions: Premium and Basic

Technical features

- Grid dimension 200 mm
- Fully assembled including clamping pins
- Premium version with additional adaption for module units
- Rust protected

Standard equipment

Clamping pallet fully assembled with
1 centering pin (type A),
1 sword pin (type B),
Transport screws

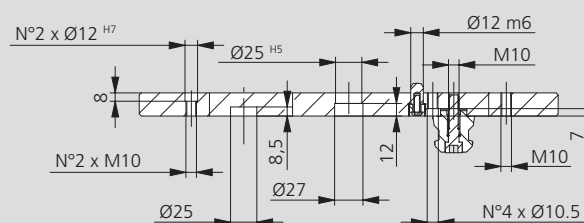
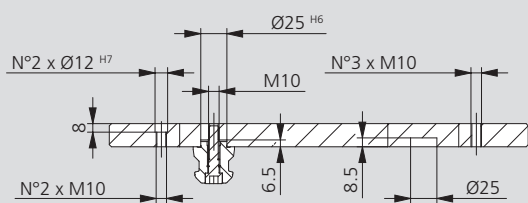
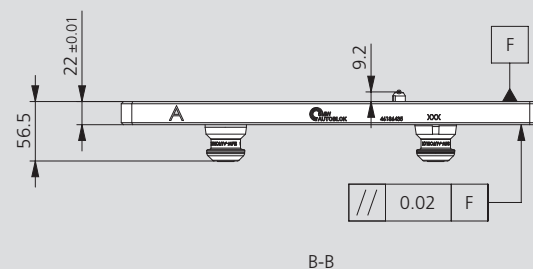
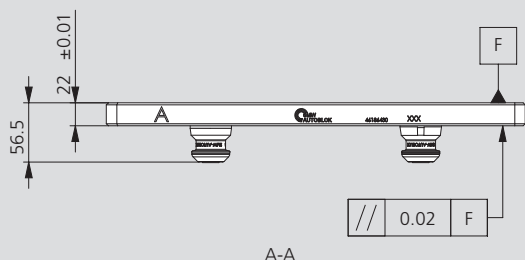
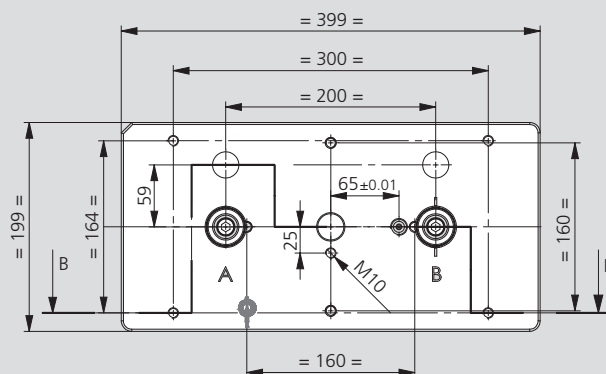
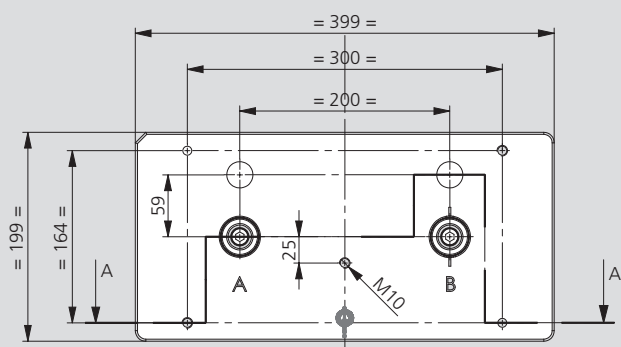

BASIC VERSION

PREMIUM VERSION

Subject to technical changes.

Order numbers

Type	Id. No.
Clamping pallet APS 140 Premium	46186435
Clamping pallet APS 140 Basic	46186430

- Basic
- Premium



Application/customer benefits

- Pre-assembled clamping pallet for APS 140
- Universal applicable
- 2 Versions: Premium and Basic

Technical features

- Grid dimension 200 mm
- Fully assembled including clamping pins
- Premium version with additional adaption for module units
- Rust protected

Standard equipment

Clamping pallet fully assembled with
 1 centering pin (Type A),
 1 sword pin (Type B),
 2 clamping pins (Type C),
 Transport screws

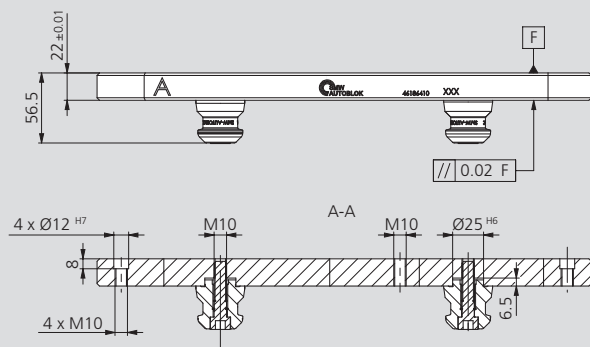
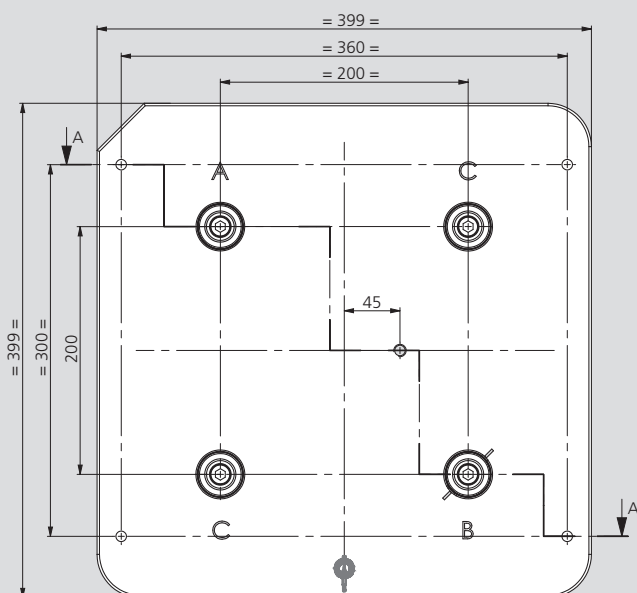

BASIC VERSION

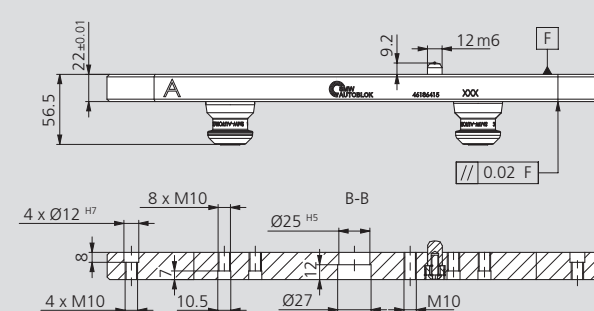
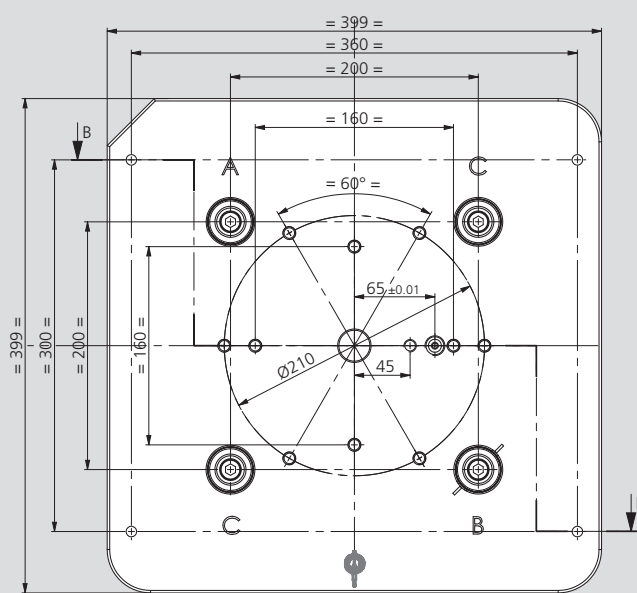

PREMIUM VERSION

Subject to technical changes.

Order numbers

Type	Id. No.
Clamping pallet APS 140 Premium	46186415
Clamping pallet APS 140 Basic	46186410

Q400

Clamping Pallet Q400

■ Pallet prepared for mounting SGSF chuck

This pallet is prepared
for loading with robots.

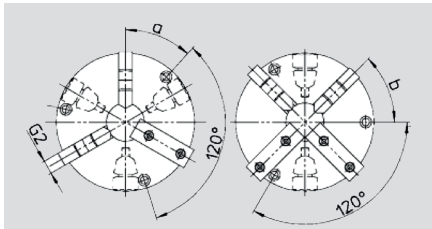

Chuck type SGS-SGSF		200-55	250-76	315-103
Front thread 3+3		33031220	33031225	33031231
Front thread 4+4		33033220	33033225	33033231
	Set-3 GRC	03652030	03652530	03653130
	Set-4 GRC	03652040	03652540	03653140
	Set-3 Soft jaws	03602030	03602530	03603130
	Set-4 Soft jaws	03602040	03602540	03603140

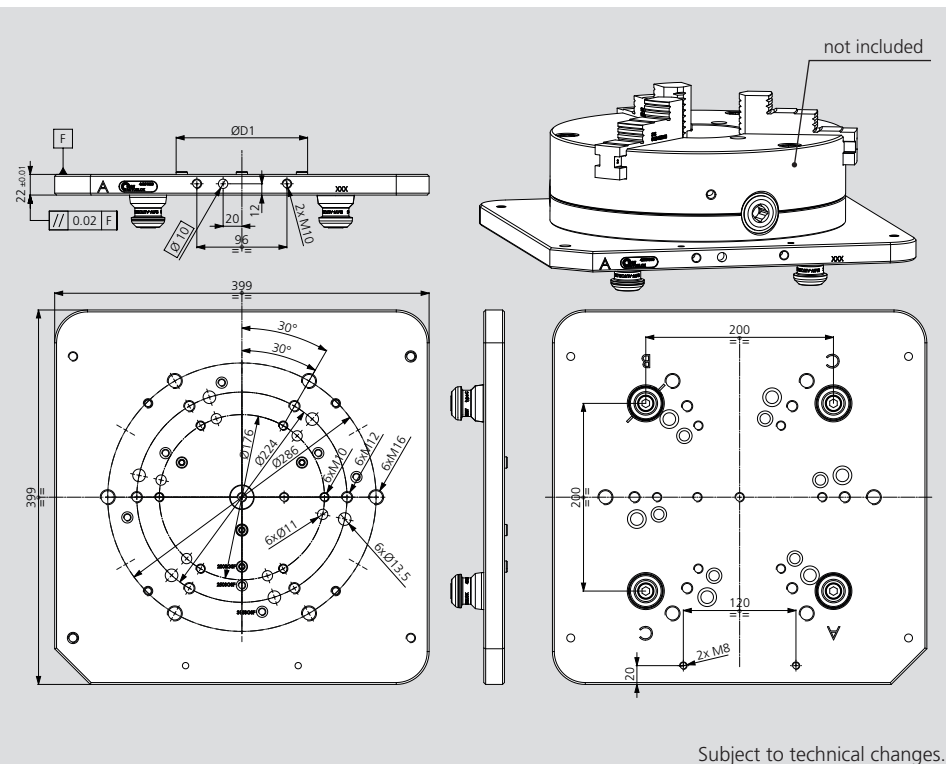

Subject to technical changes.

Type pallet (without chuck)	Id. No.	Weight [kg]	Manual chucks SGSF (optional)	
Pallet Q400 prepared for chucks 200-250-315 SGSF handling robot	46201020	28	Ø D1	Chuck model
			159.9	200 SGSF
			199.9	250 SGSF
			259.9	315 SGSF

Q400

Clamping Pallet Q400

■ Pallet prepared for mounting HG-N chucks

This pallet is prepared for loading with robots. For information on HG chucks see page 320 - 339

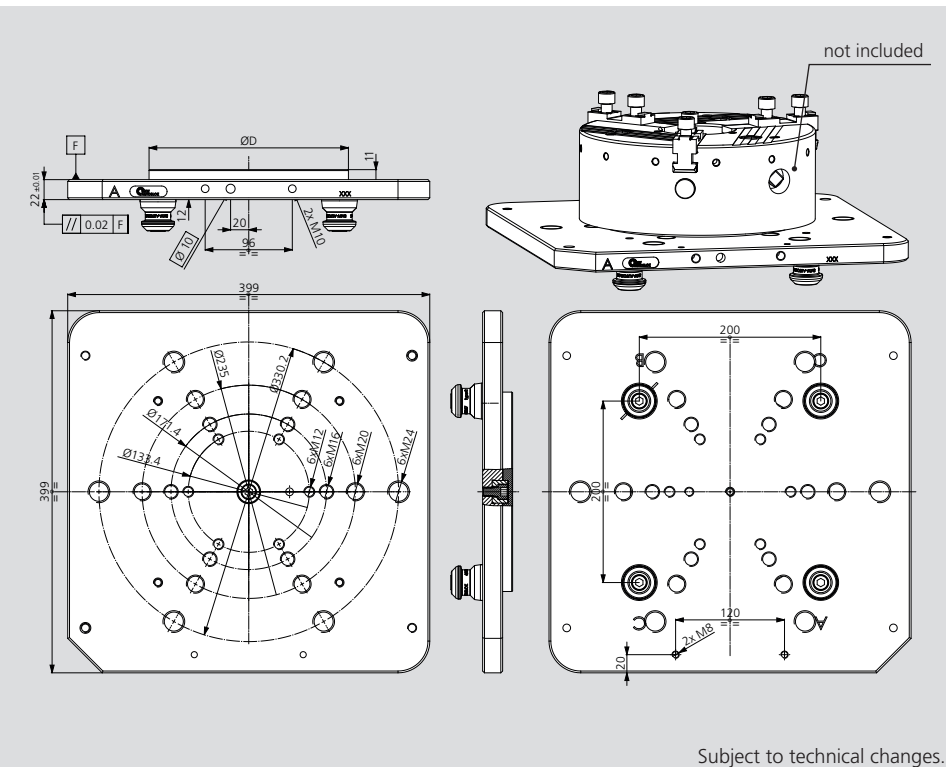

Subject to technical changes.

Type pallet (without chuck)	Id. No.	ØD	Weight [kg]
GRP pallet Q400 + mounting D220 AUTC 260HG loading robot	46201012	219.7	30
GRP pallet Q400 + mounting D300 AUTC 315HG loading robot	46201013	299.7	32
GRP pallet Q400 + mounting D380 AUTC 400-500HG manual loading	46201014	379.7	36

Clamping pallet for automation with MC150x200 vises

■ Pallet prepared for mounting 1 vise

4 APS 140

0

This pallet is **not** prepared for handling with robots.
For information on MC vises see page 283 - 288

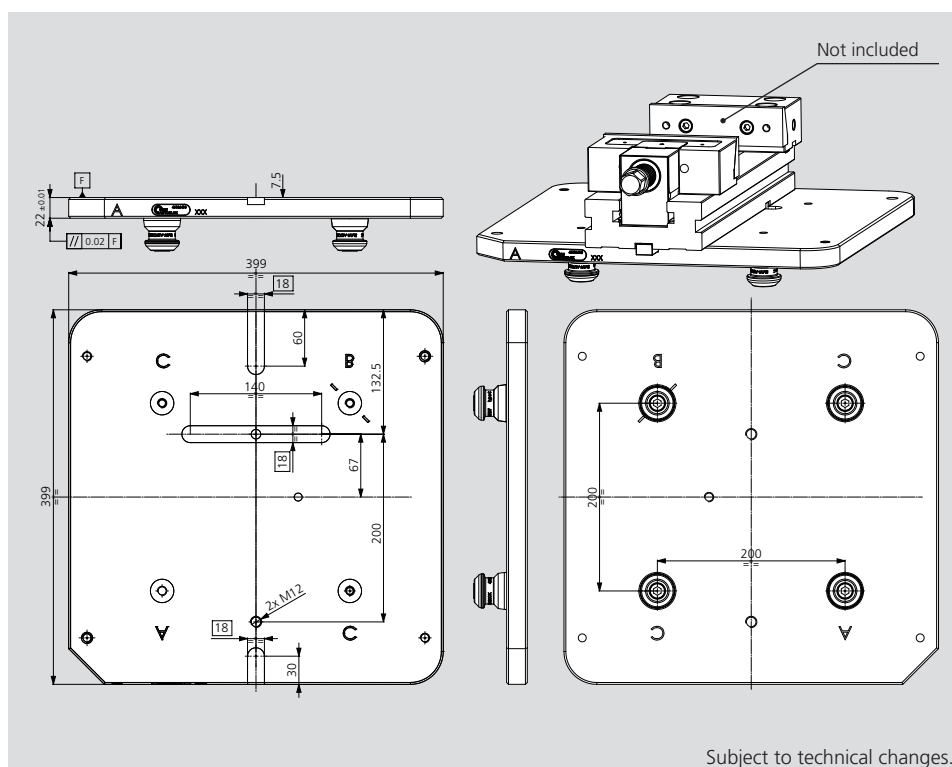

Type pallet (without vise)

Pallet Q400 prepared for 1 vise MC150x200 manual loading

Id. No.

41702271

Weight [kg]

28

Clamping pallet for automation with MC150x200 vises

■ Pallet prepared for mounting 2 vises

4 APS 140

This pallet is prepared for handling with robots.
For information on MC vises see page 283 - 288

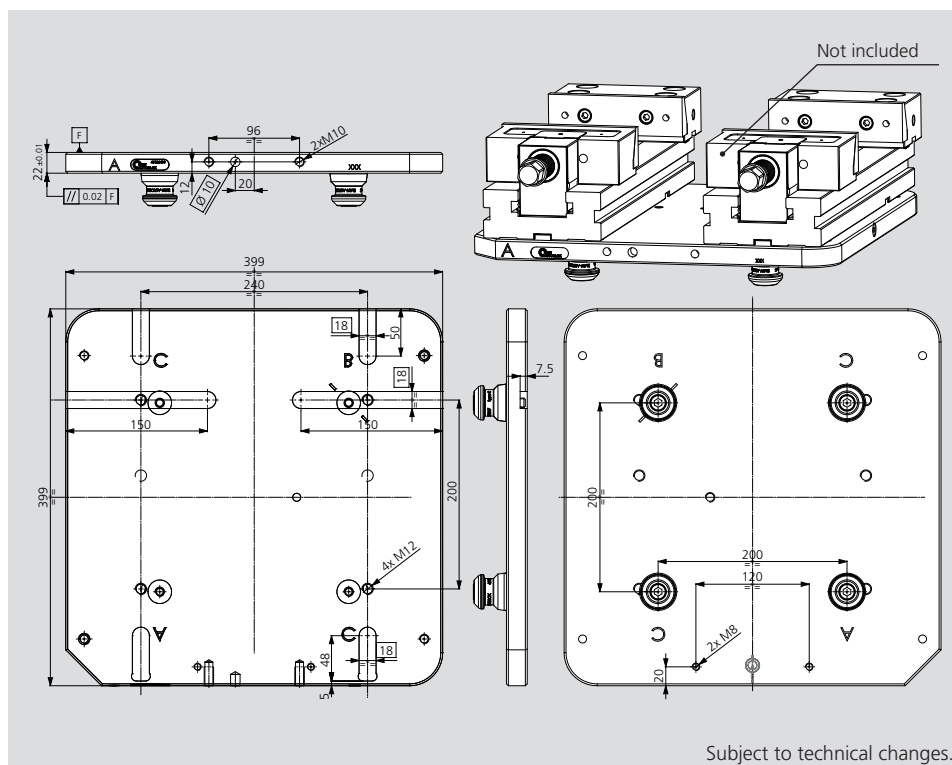

Type pallet (without vise)

Pallet Q400 prepared for 2 vises MC150x200 robot loading

Id. No.

41702261

Weight [kg]

28